



EVOTECH[®]
P E R F O R M A N C E

**Z900 Kawasaki
Tail Tidy**

Installation Instructions

Kit Contents PRN013818

- A** 1 x Upper Bracket
- B** 1 x Lower Bracket
- C** 1 x Base Plate
- D** 1 x Number Plate Bracket
- E** 1 x Retro Light
- F** 1 x Loom Connector 5
- G** 2 x M6 Flange Nut
- H** 2 x M4 Flange Nut
- I** 2 x M4 x 6 Black Button Head Bolts
- J** 2 x M4 Black Washers
- K** 3 x M5 x 12 Countersunk Screws
- L** 4 x M6 Black Washers
- M** 6 x M6 x 16 Black Button Head Bolts

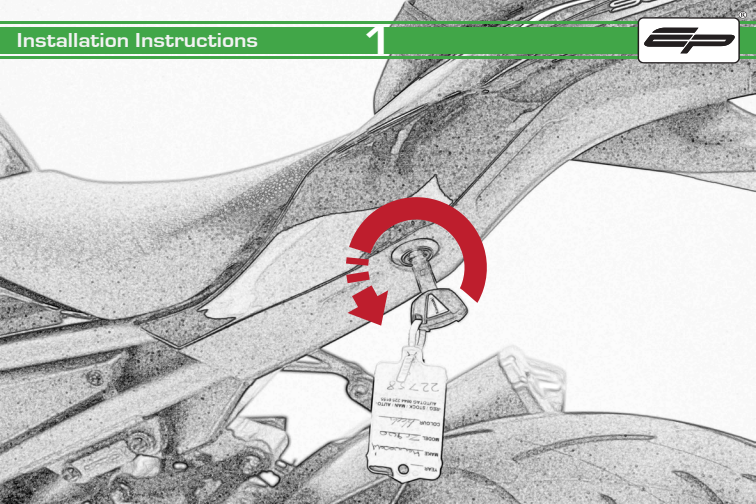



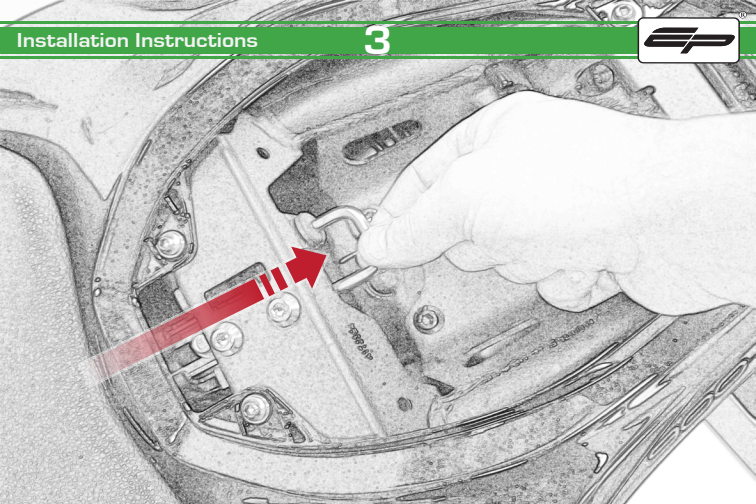

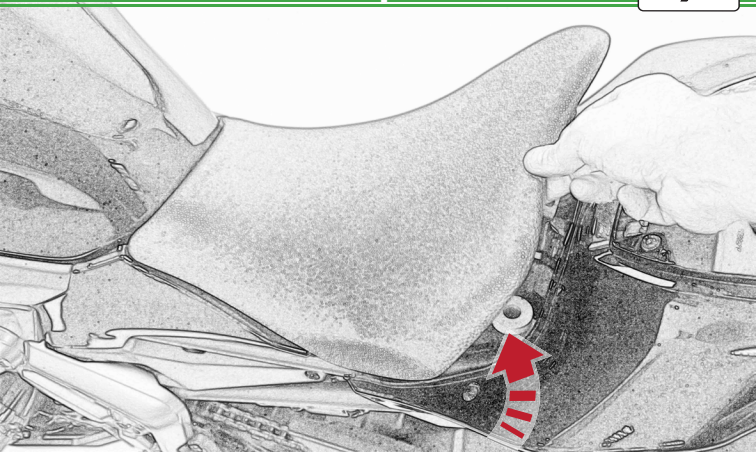

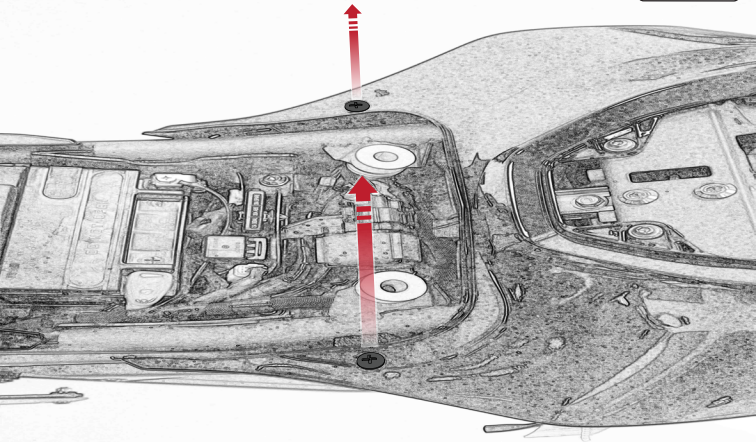

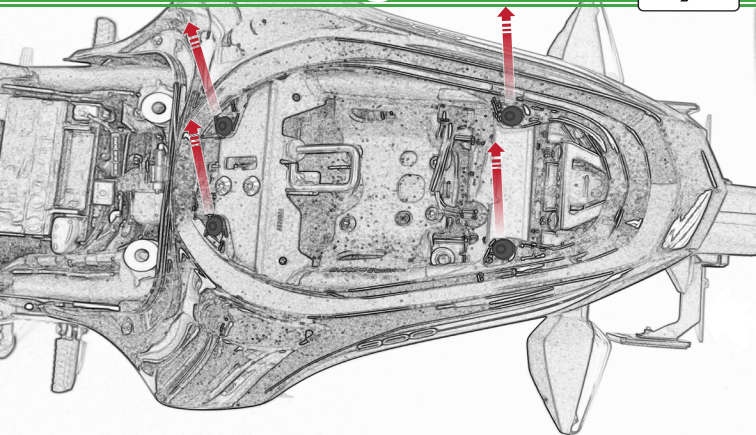

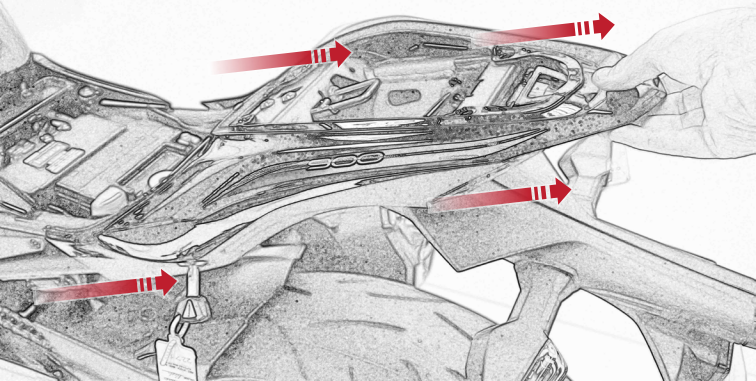

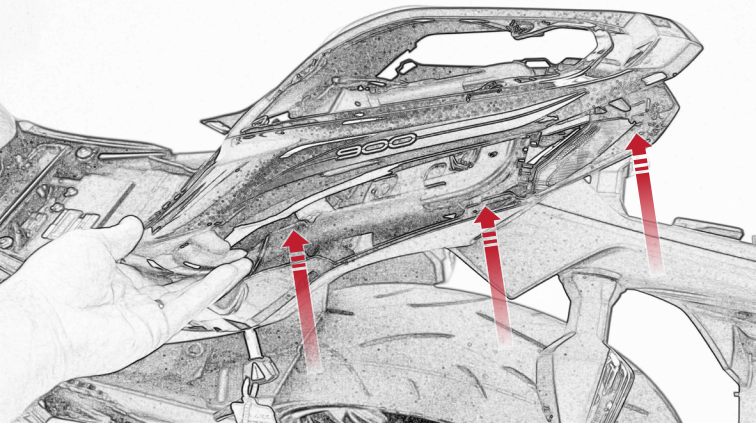

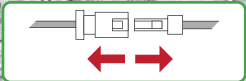
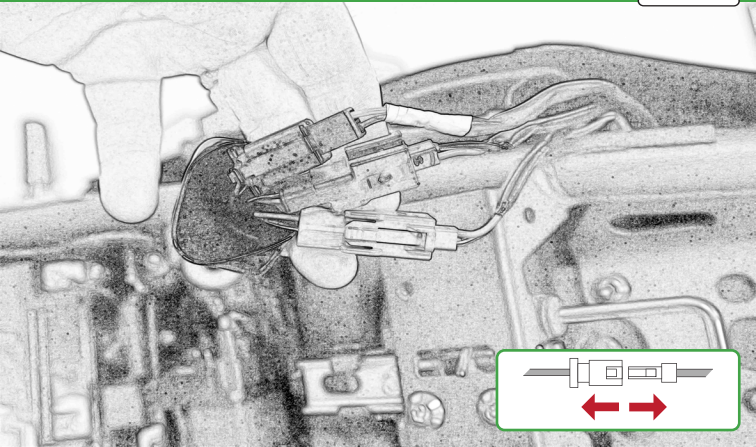

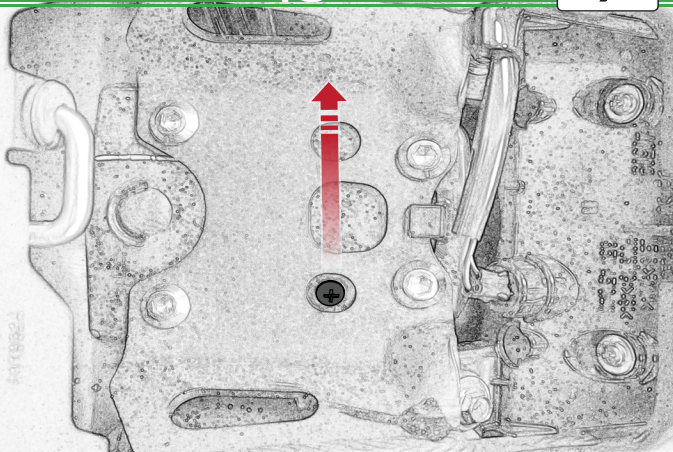

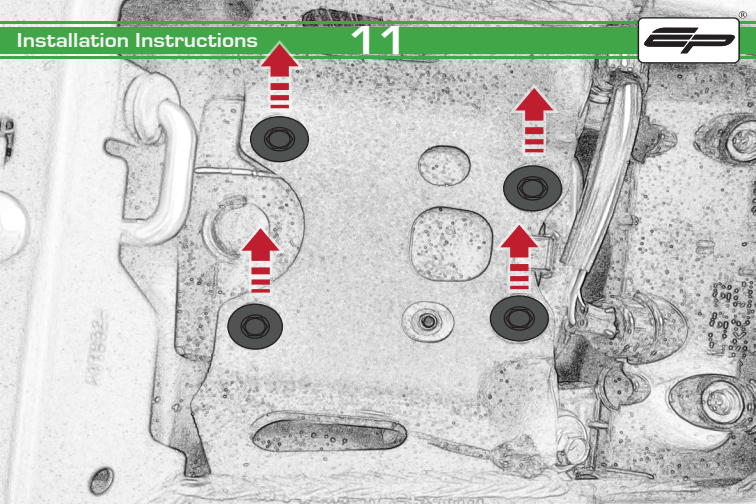

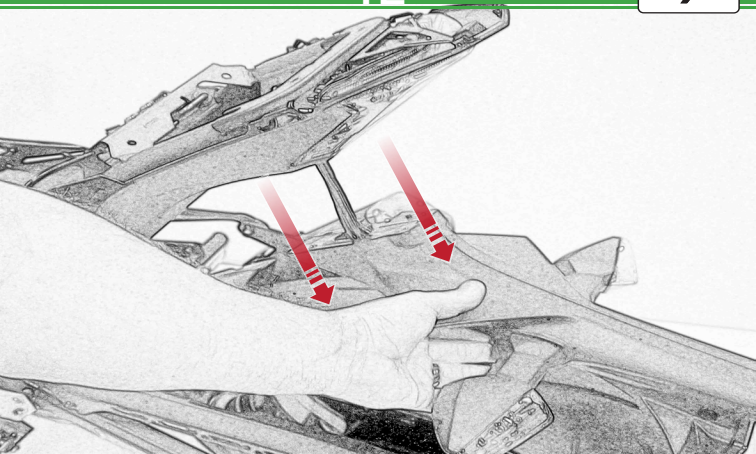

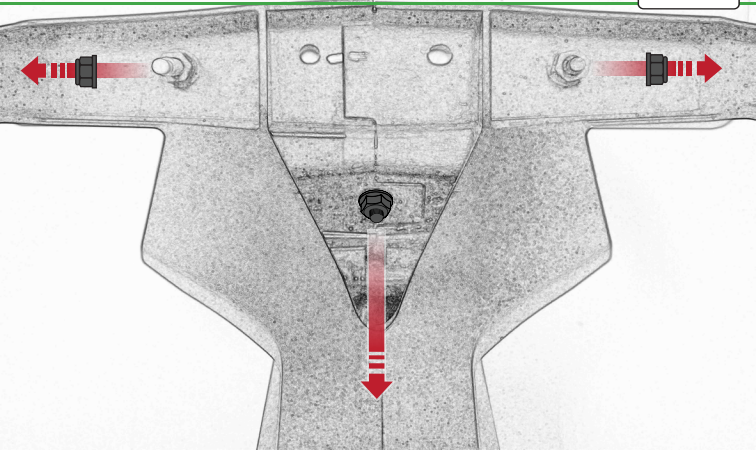

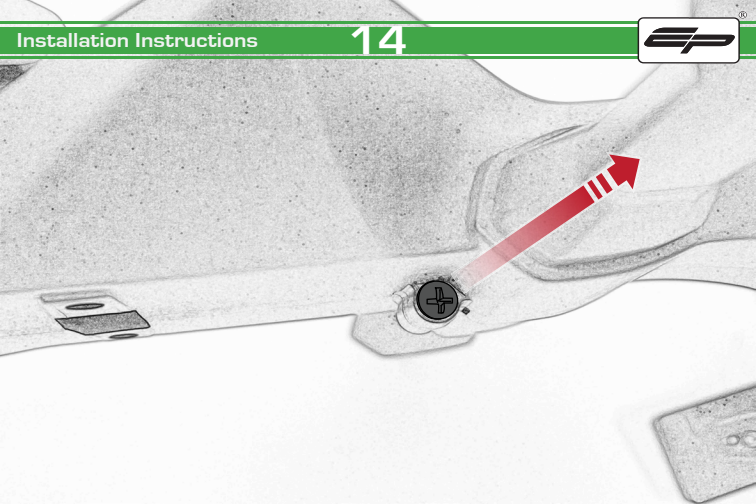

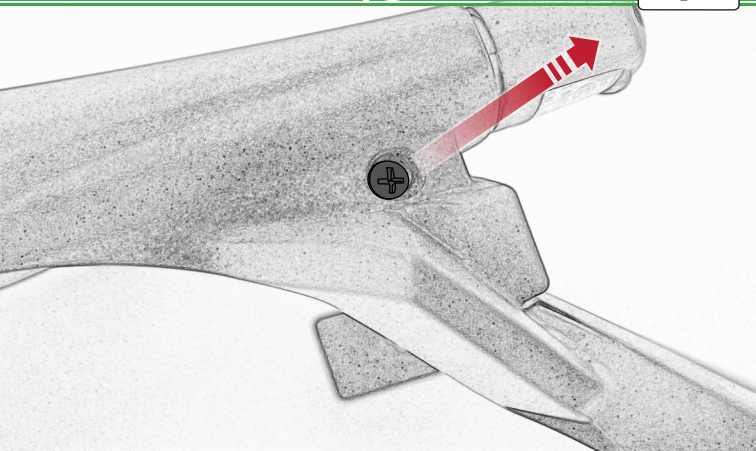

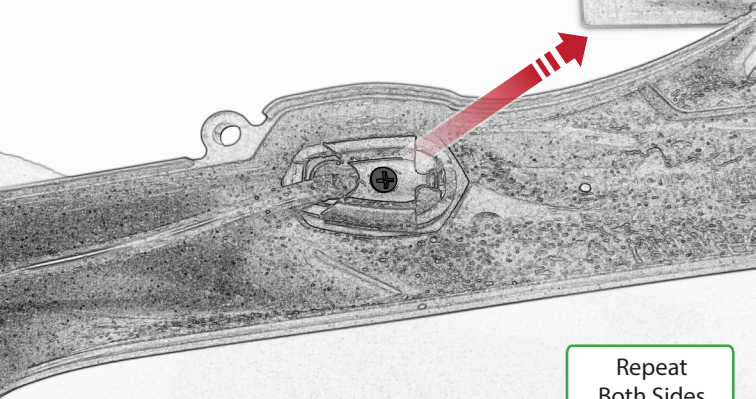

Repeat
Both Sides

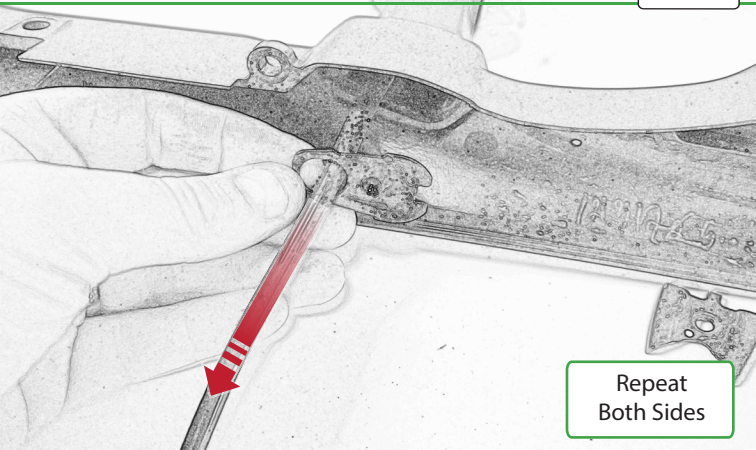

Repeat
Both Sides

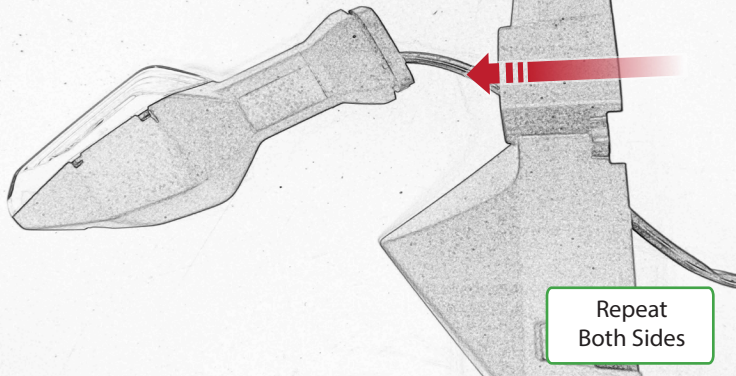

Repeat
Both Sides

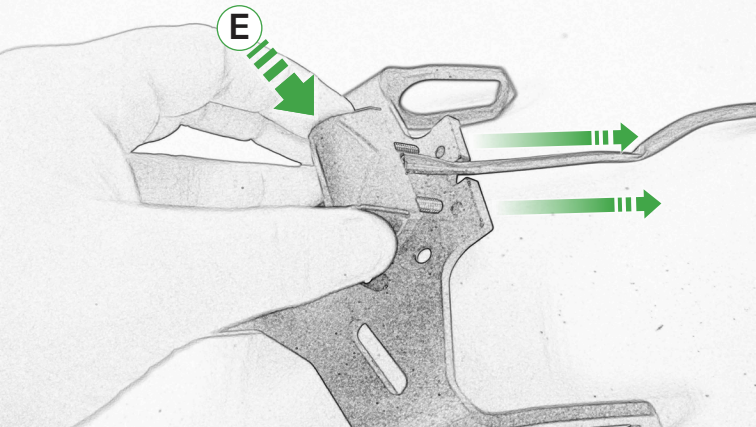

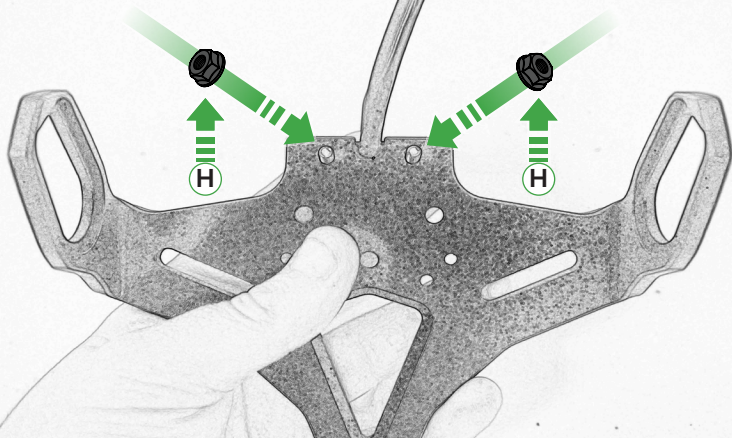

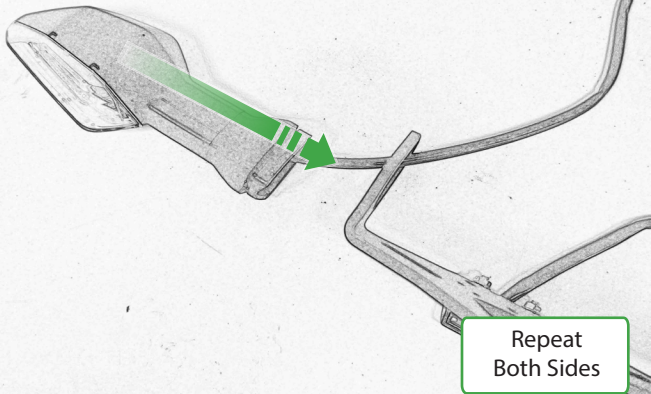

Repeat
Both Sides

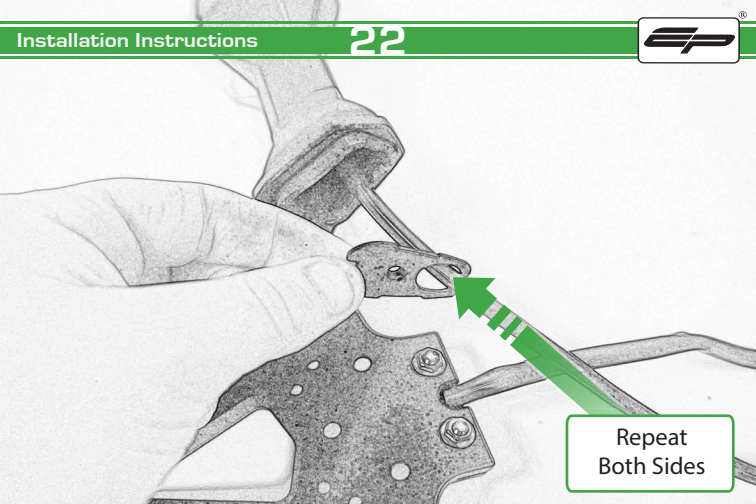

Repeat
Both Sides

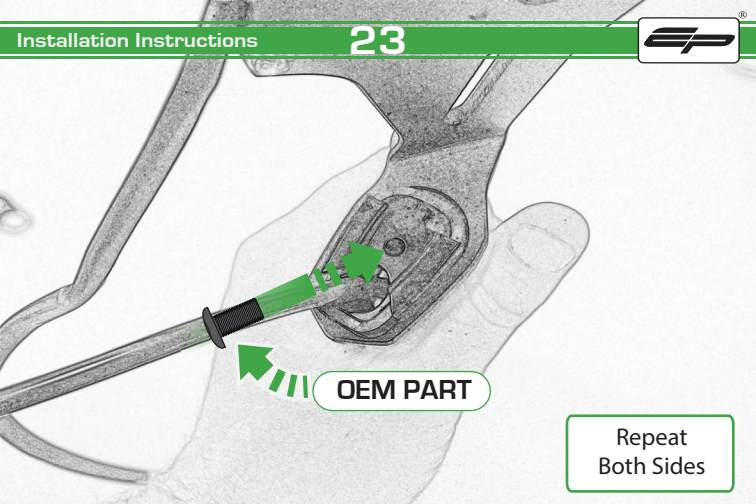

OEM PART

Repeat
Both Sides

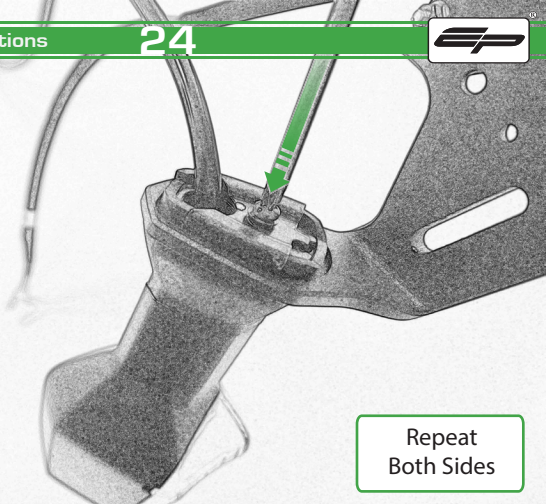

Repeat
Both Sides

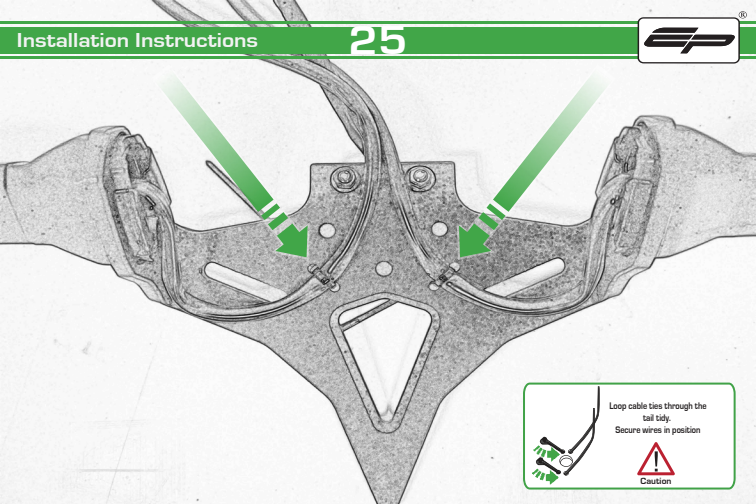

Loop cable ties through the
tail tidy.
Secure wires in position



Caution

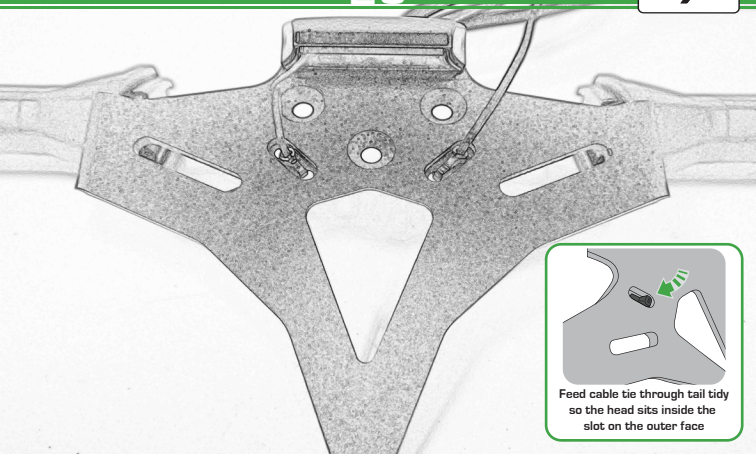

Feed cable tie through tail tidy so the head sits inside the slot on the outer face

The inset diagram shows a close-up of a rectangular slot on the metal bracket. A cable tie is being inserted from the right side. A green arrow points to the head of the cable tie, which is positioned to sit inside the slot. The tail of the cable tie extends to the left.

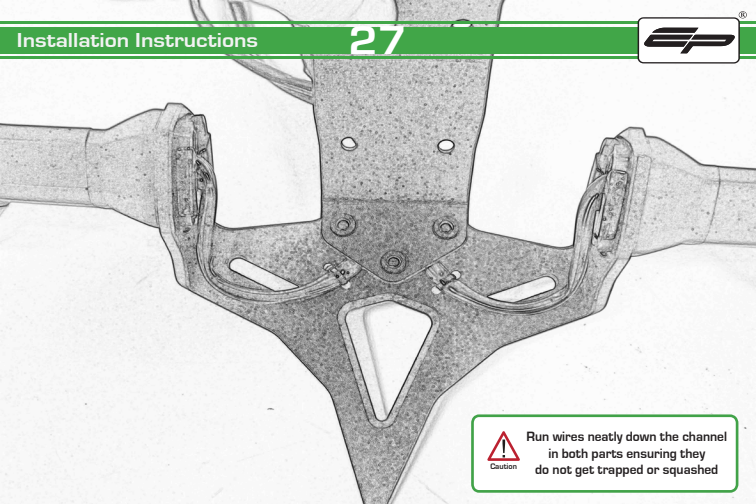

Run wires neatly down the channel
in both parts ensuring they
do not get trapped or squashed

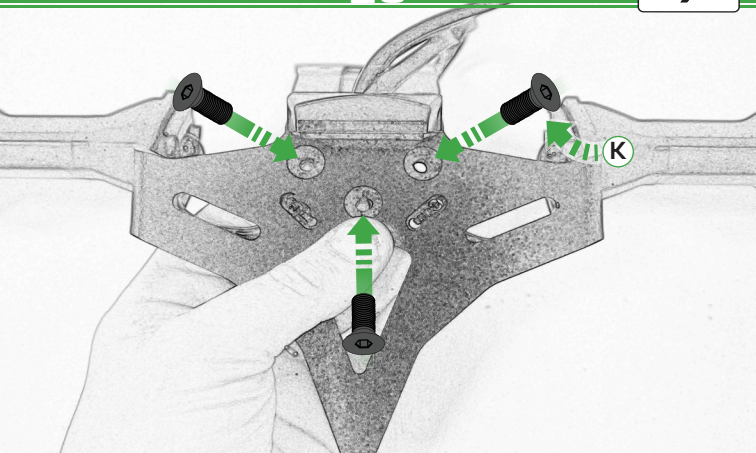

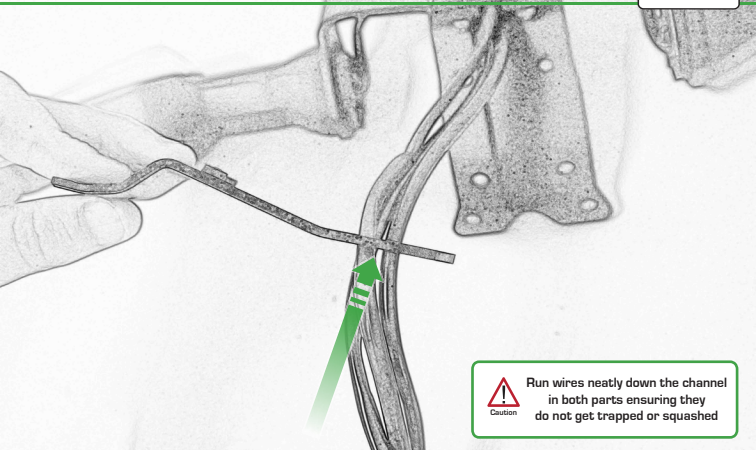

Run wires neatly down the channel in both parts ensuring they do not get trapped or squashed

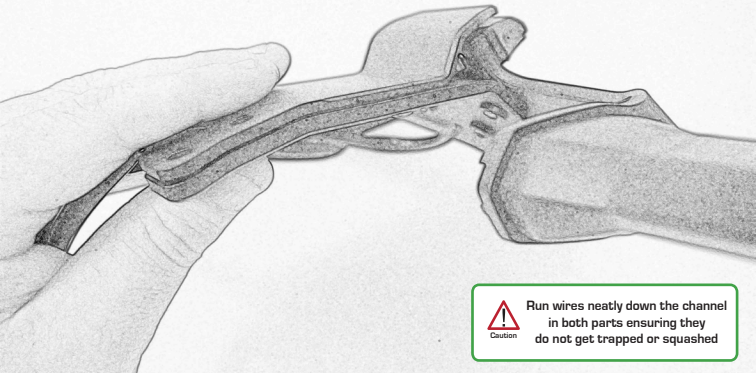

Run wires neatly down the channel in both parts ensuring they do not get trapped or squashed

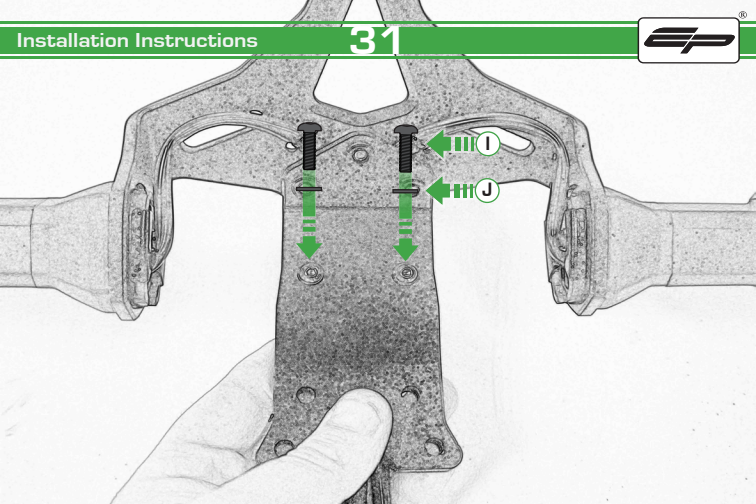

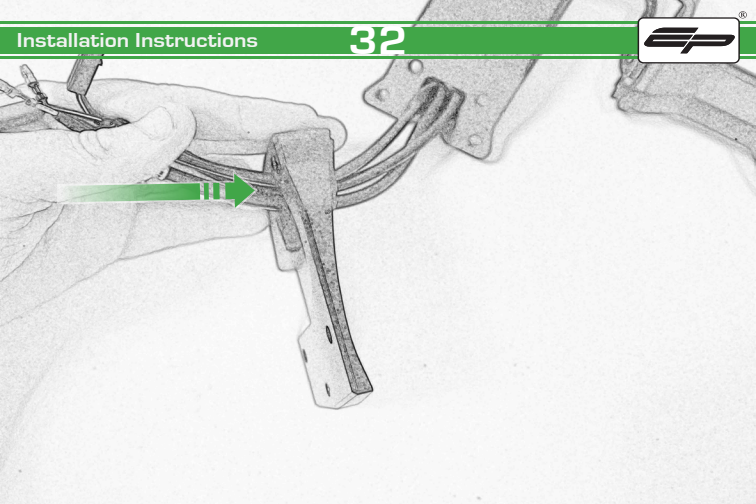

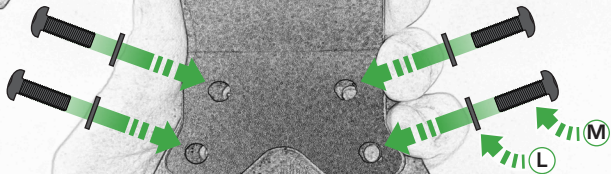

EVOTECH

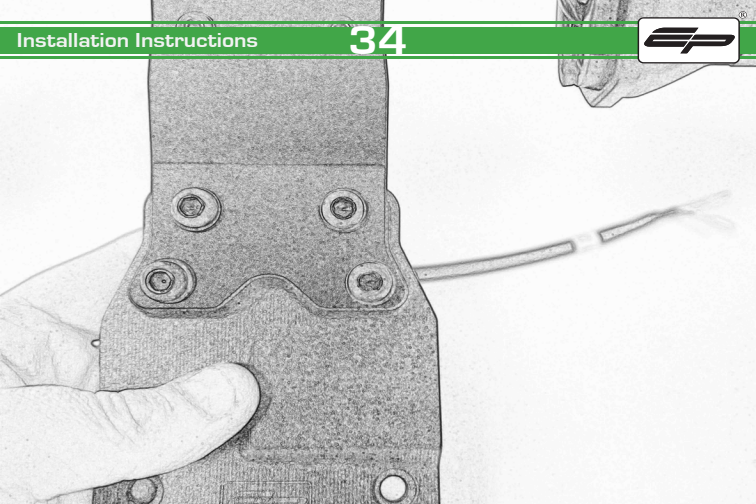



Caution

Run wires neatly down the channel in both parts ensuring they do not get trapped or squashed

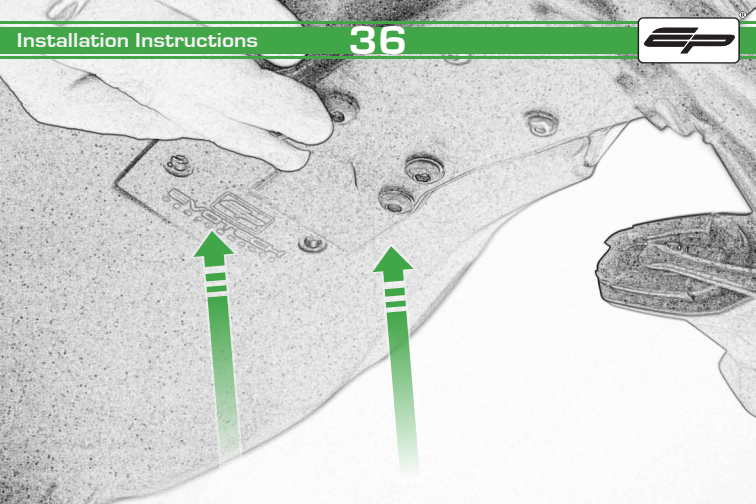



OEM PART

4370324

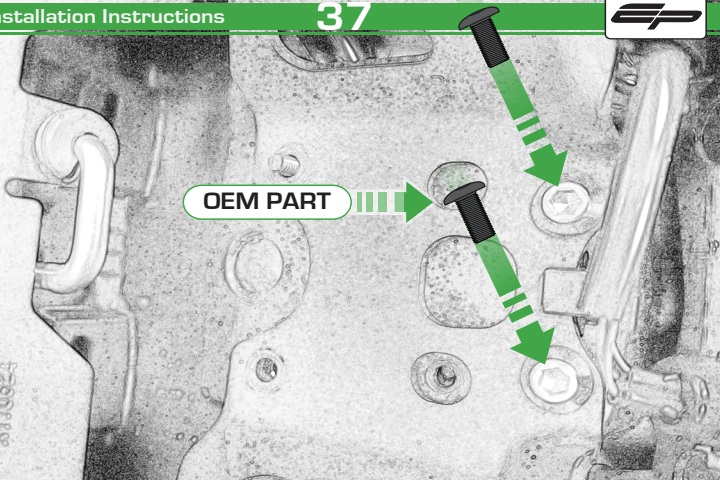

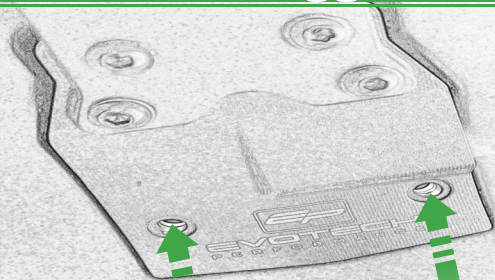

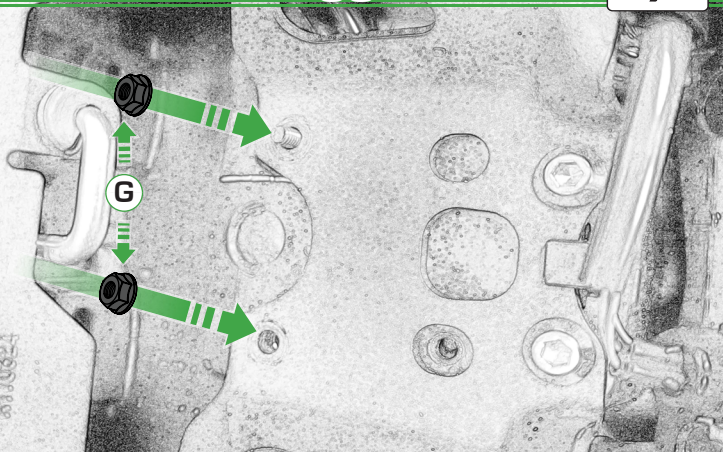

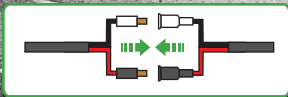
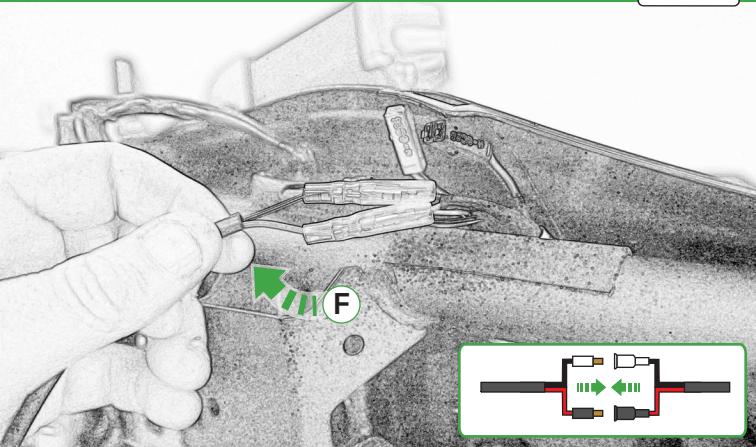

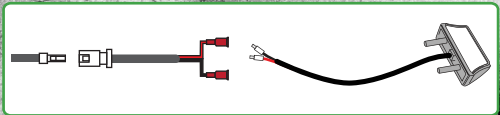
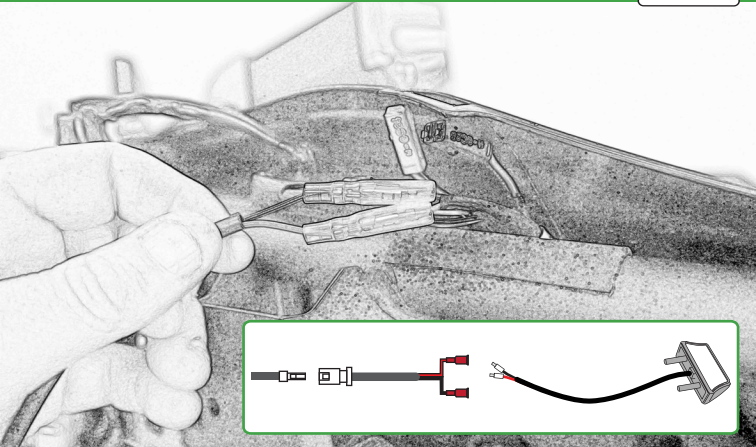

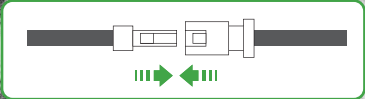
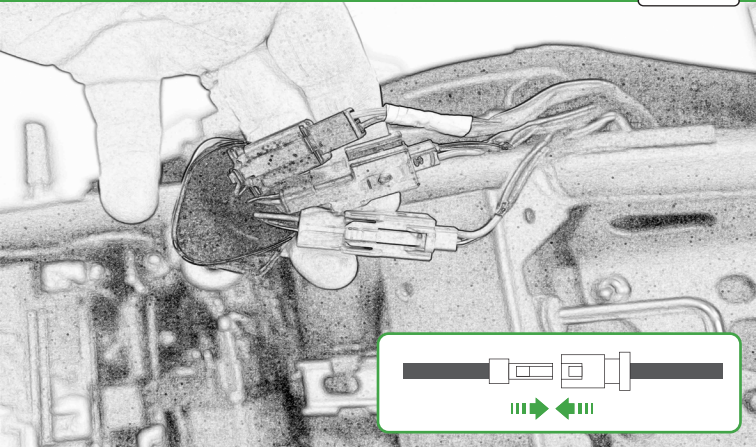

A large, light gray, stylized version of the EP logo is centered on the page, serving as a background for the text. It features a white diagonal slash through the 'P'.

Reverse Stages

A green icon consisting of two chevron-like shapes pointing to the left, positioned to the left of the text '8 - 1'.

8 - 1

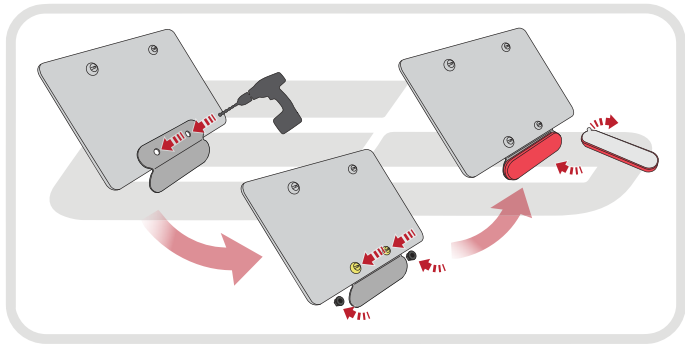

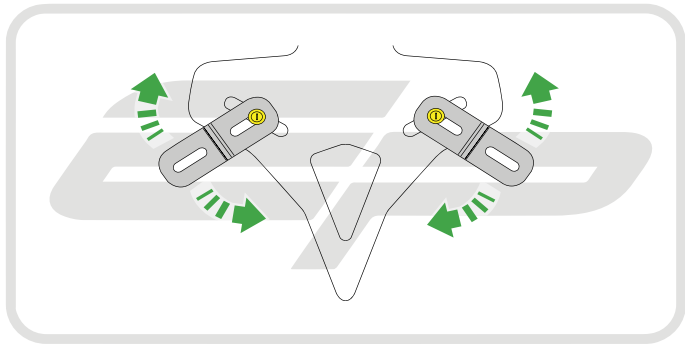



EVOTECH®
P E R F O R M A N C E

www.evotech-performance.com