



EVOTECH®
P E R F O R M A N C E

www.evotech-performance.com

Ducati Hypermotard 950 Hand Guard Installation Instructions



Kit Contents PRN014929

- Ⓐ 1 x Main Bracket L/H
- Ⓑ 1 x Mirror Brkt L/H
- Ⓒ 1 x Main Bracket R/H
- Ⓓ 1 x Main Bracket R/H
- Ⓔ 2 x Bar End Inner
- Ⓕ 2 x Bar End Outer
- Ⓖ 2 x M6 x 60 Caphead S/S
- Ⓗ 4 x M5 x 12 Black Button Head Bolts
- Ⓘ 4 x M5 Black Washer



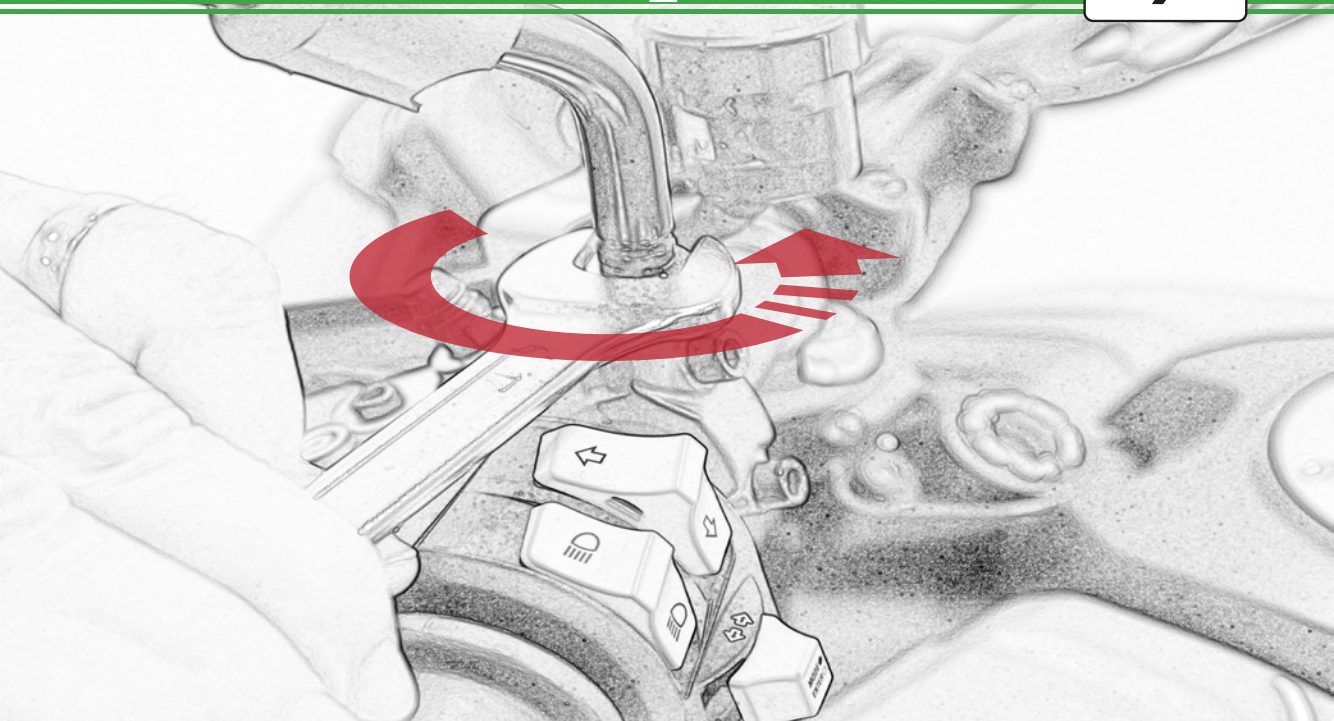

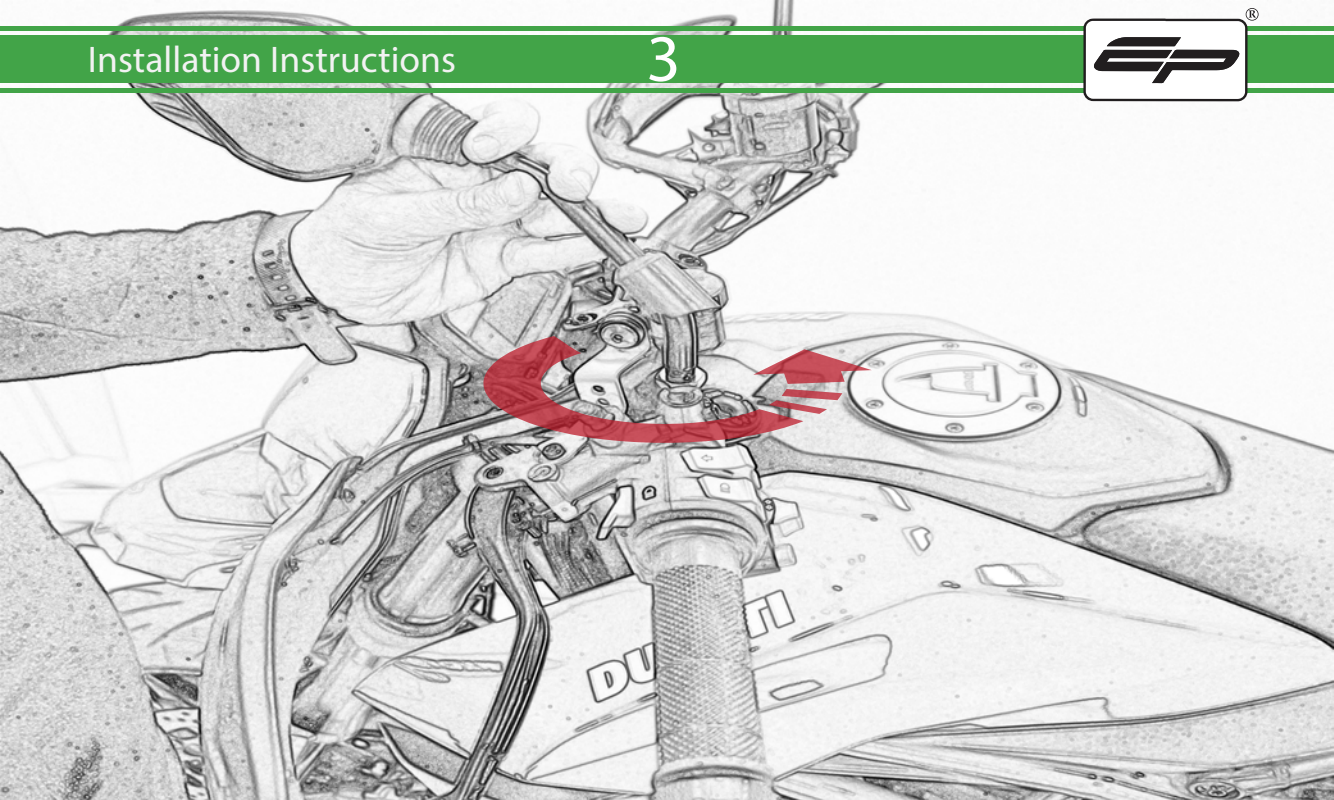



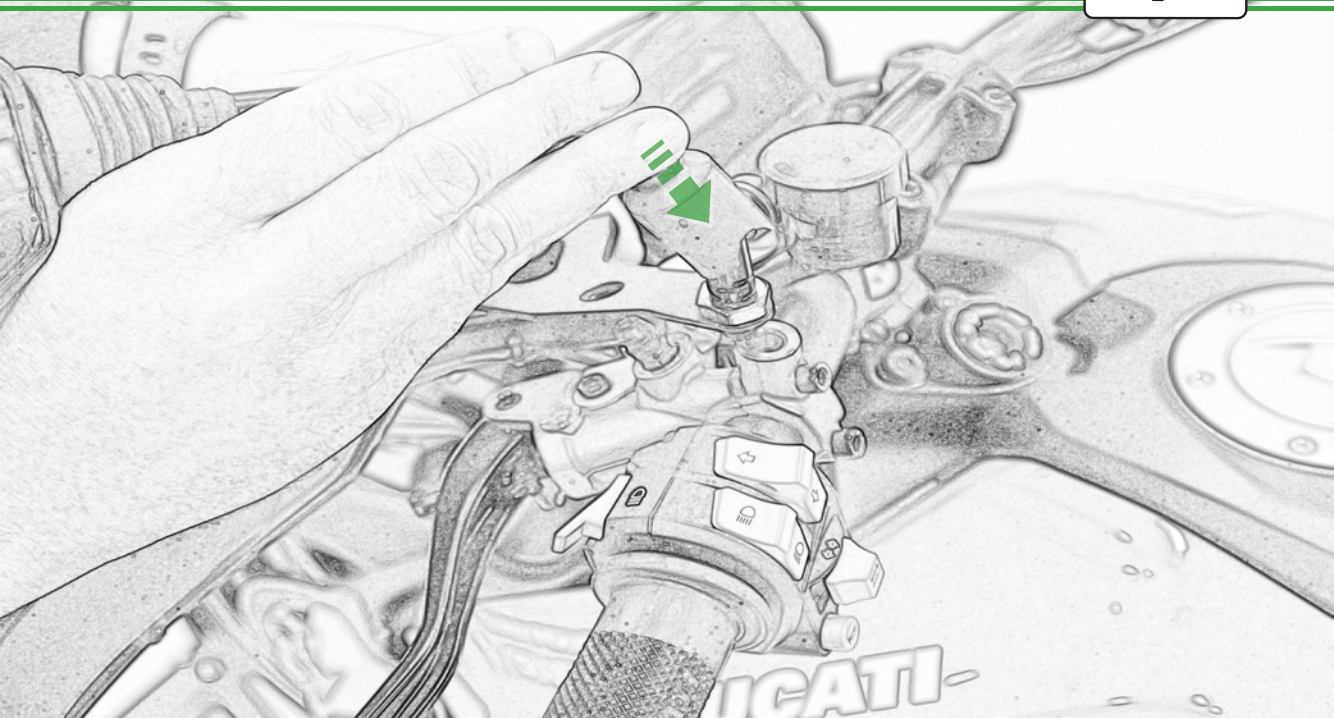

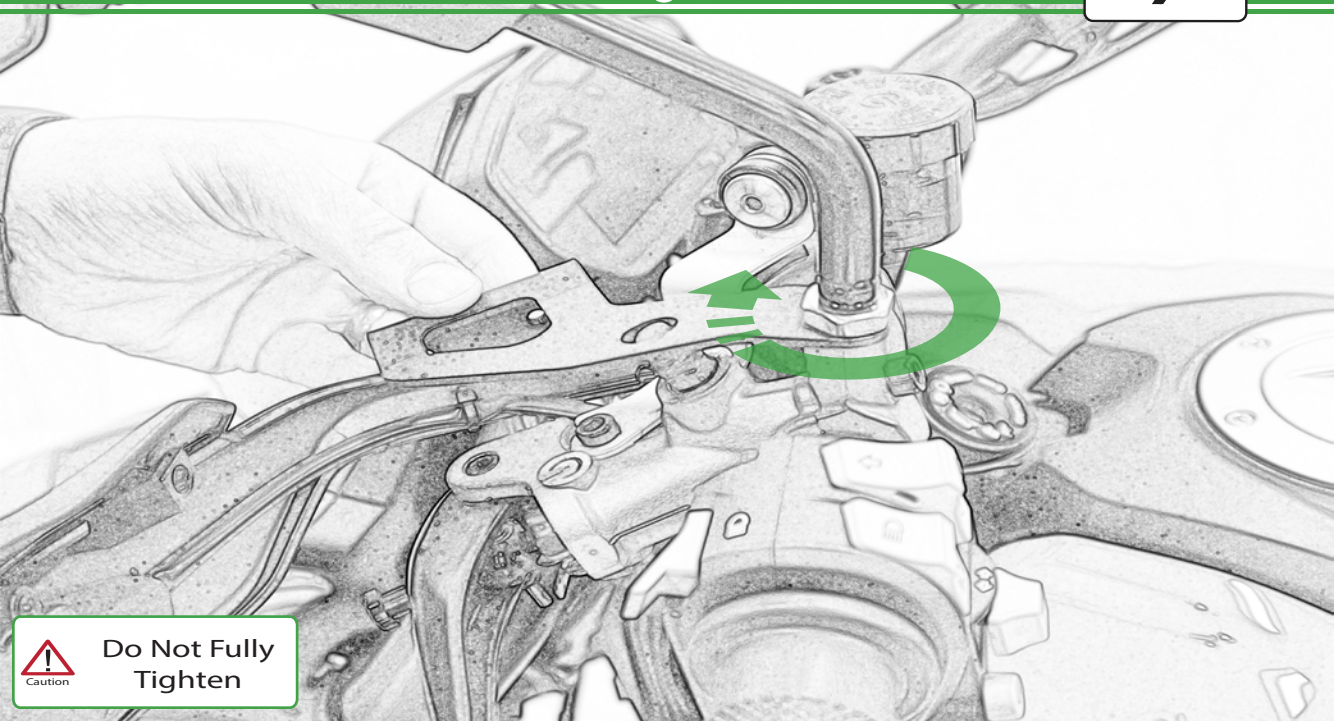

Do Not Fully
Tighten

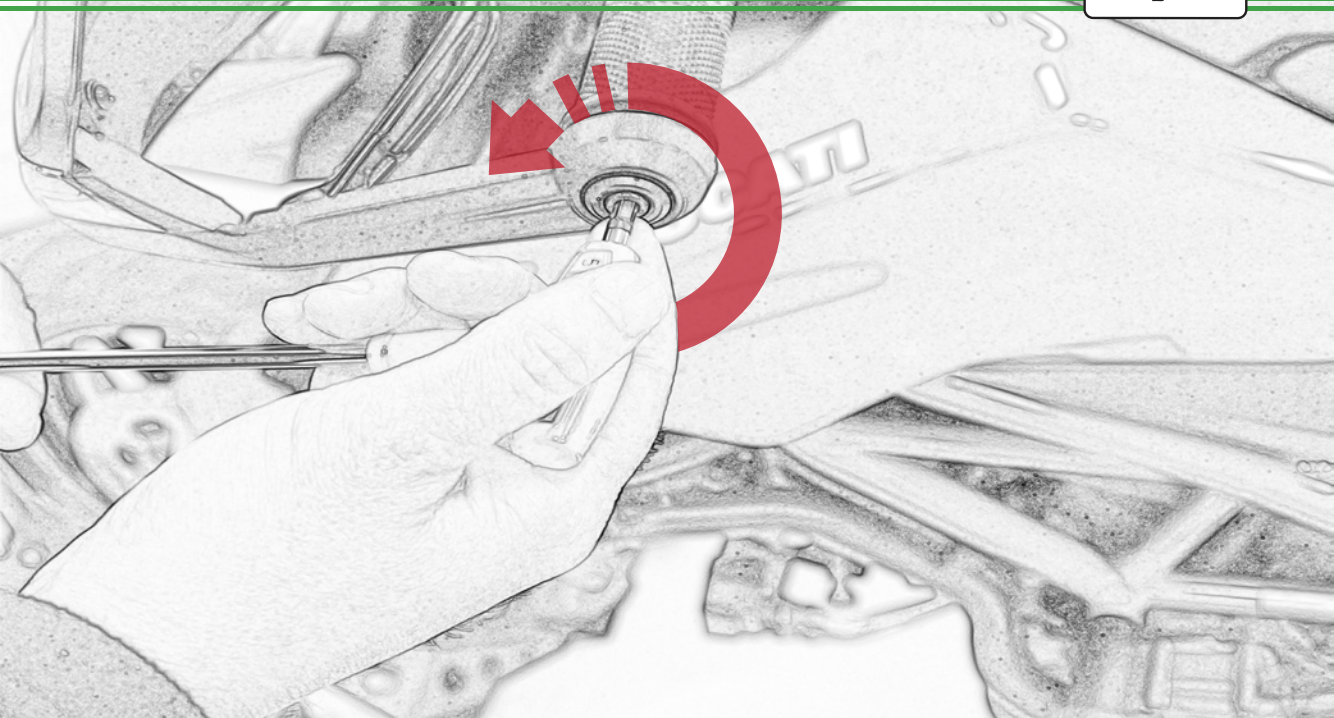

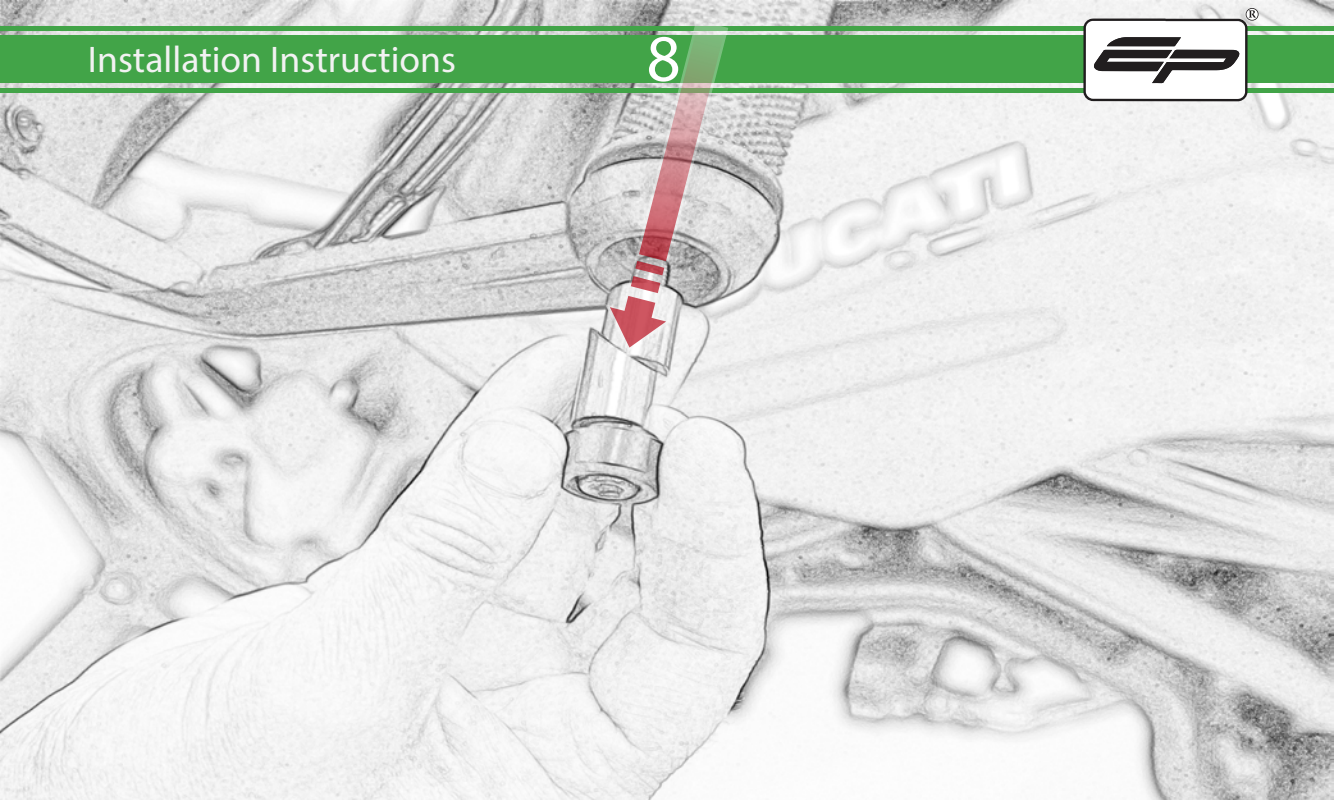

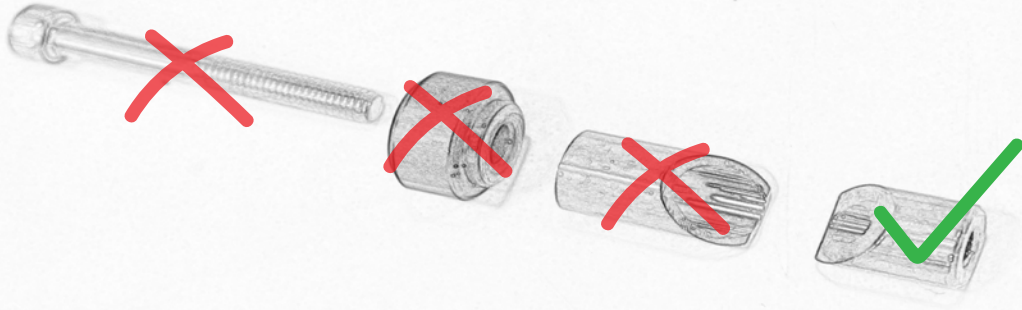

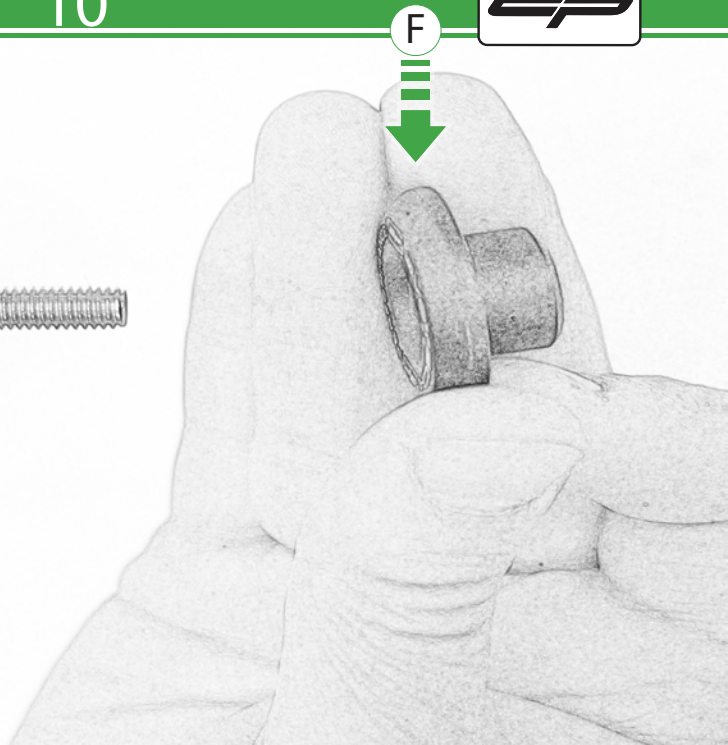
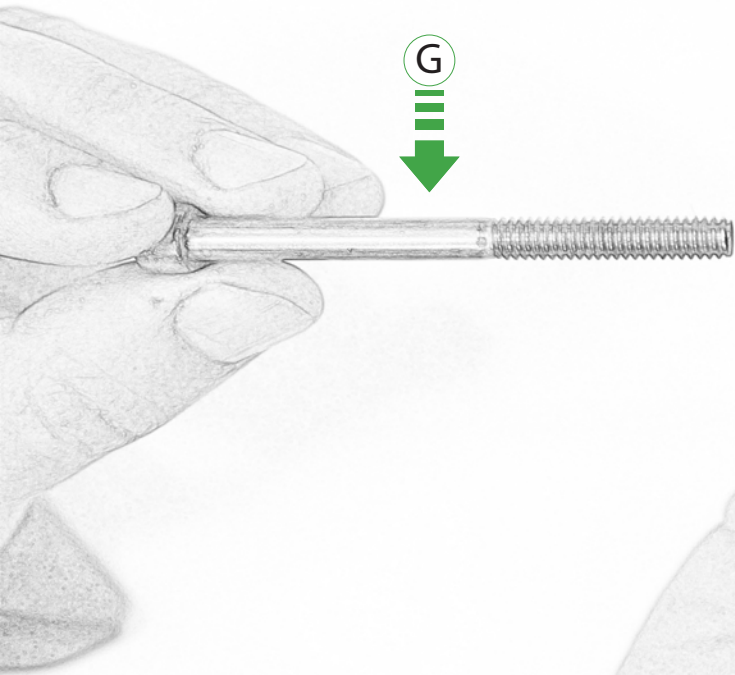

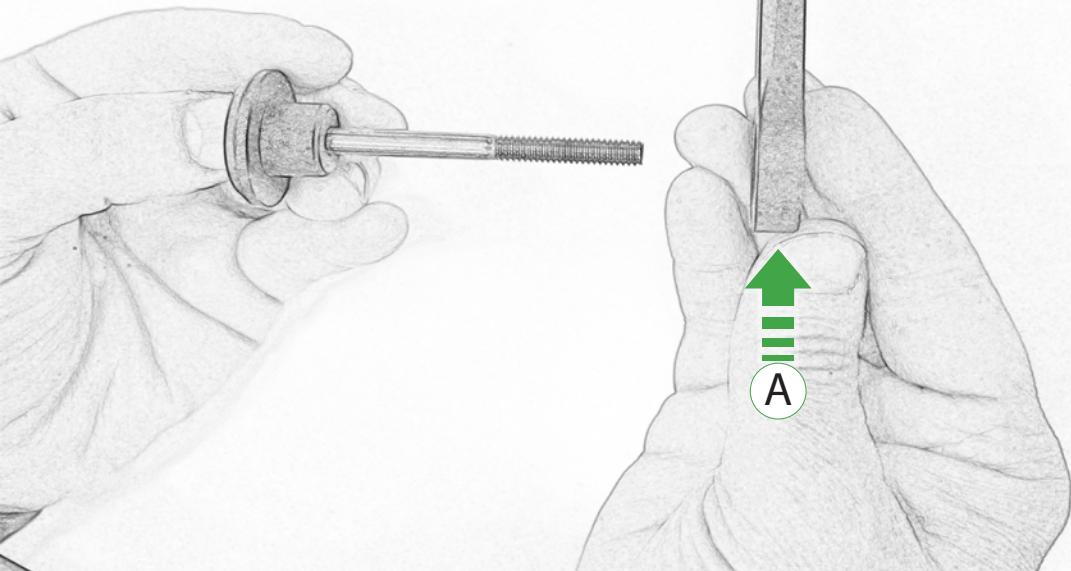

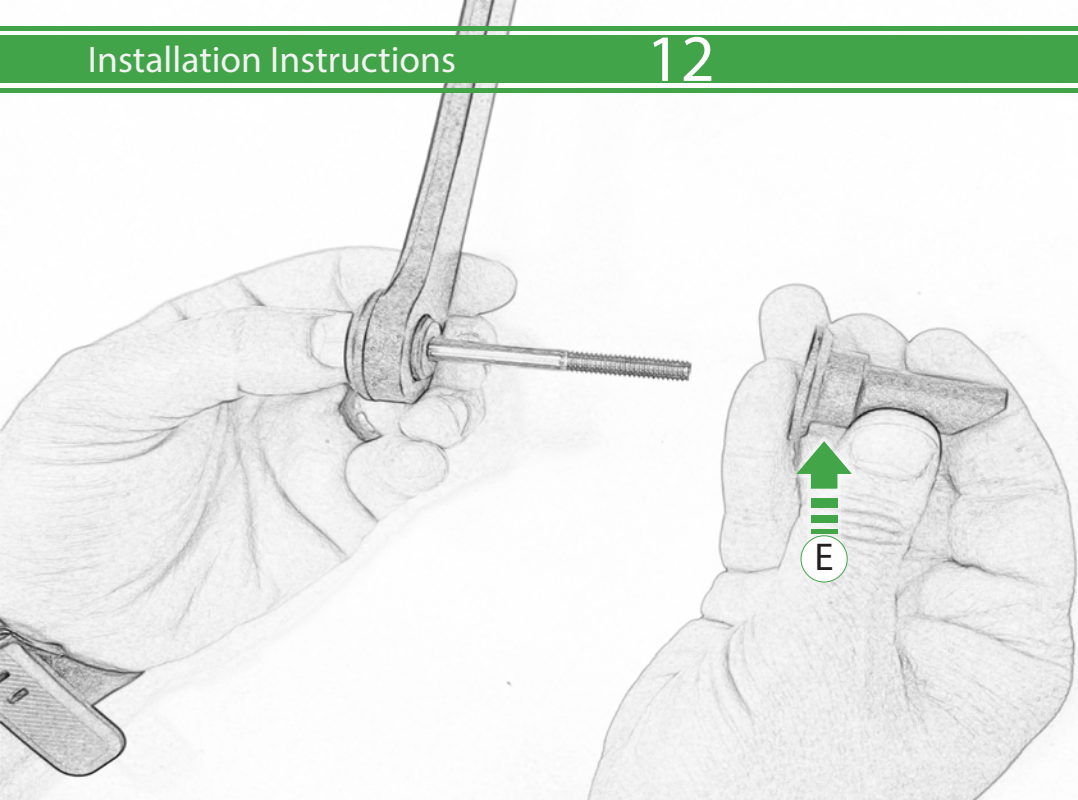



OEM PART

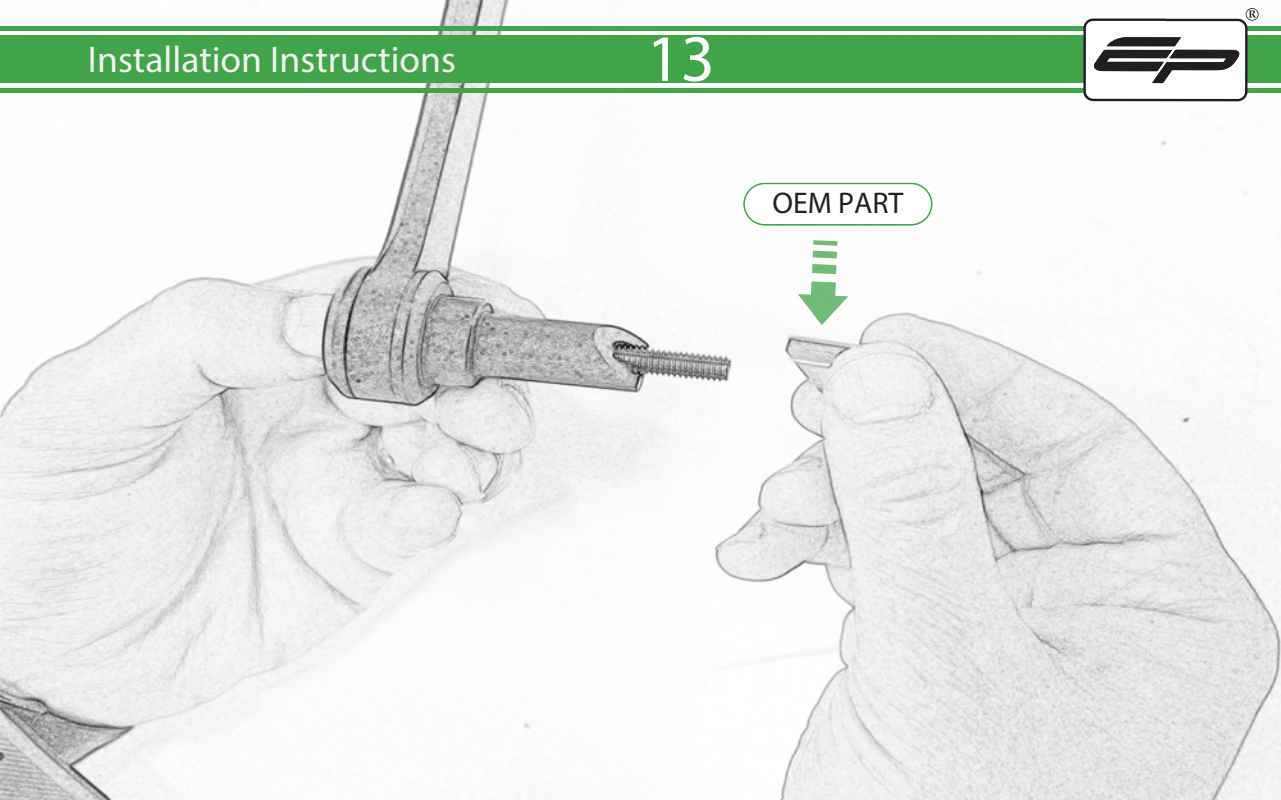

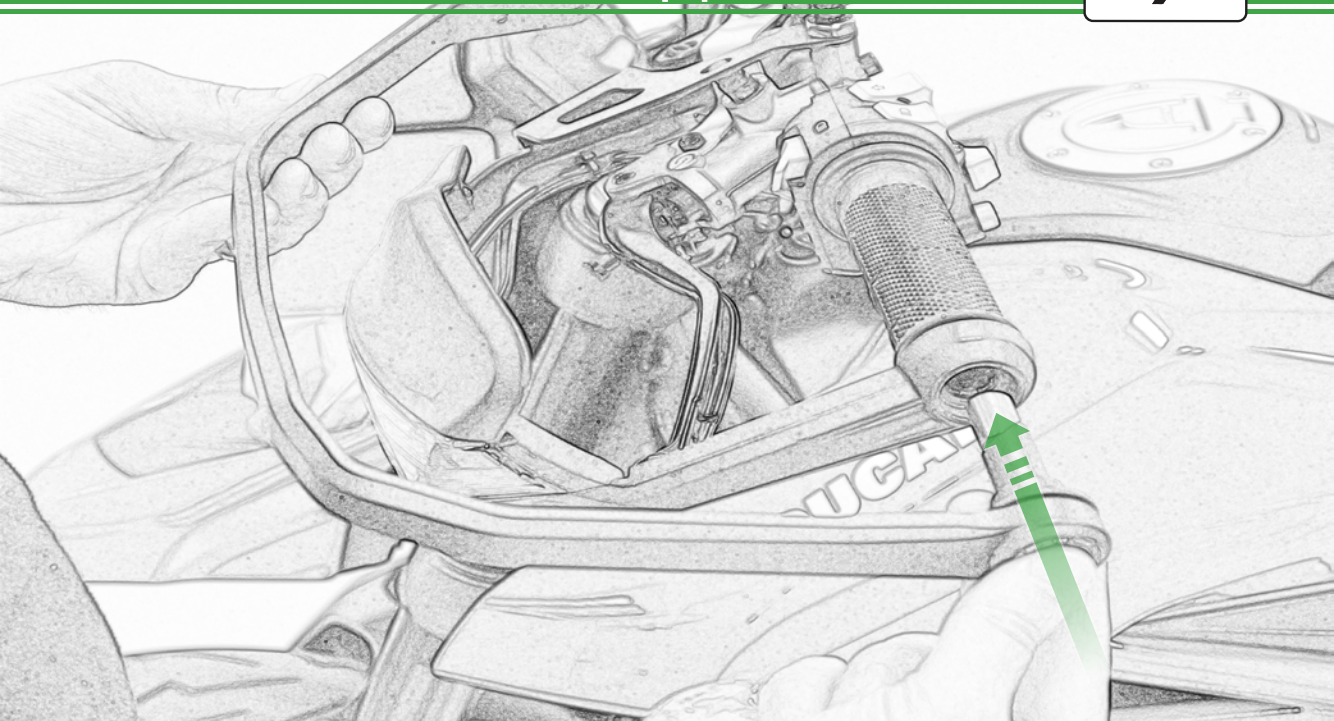

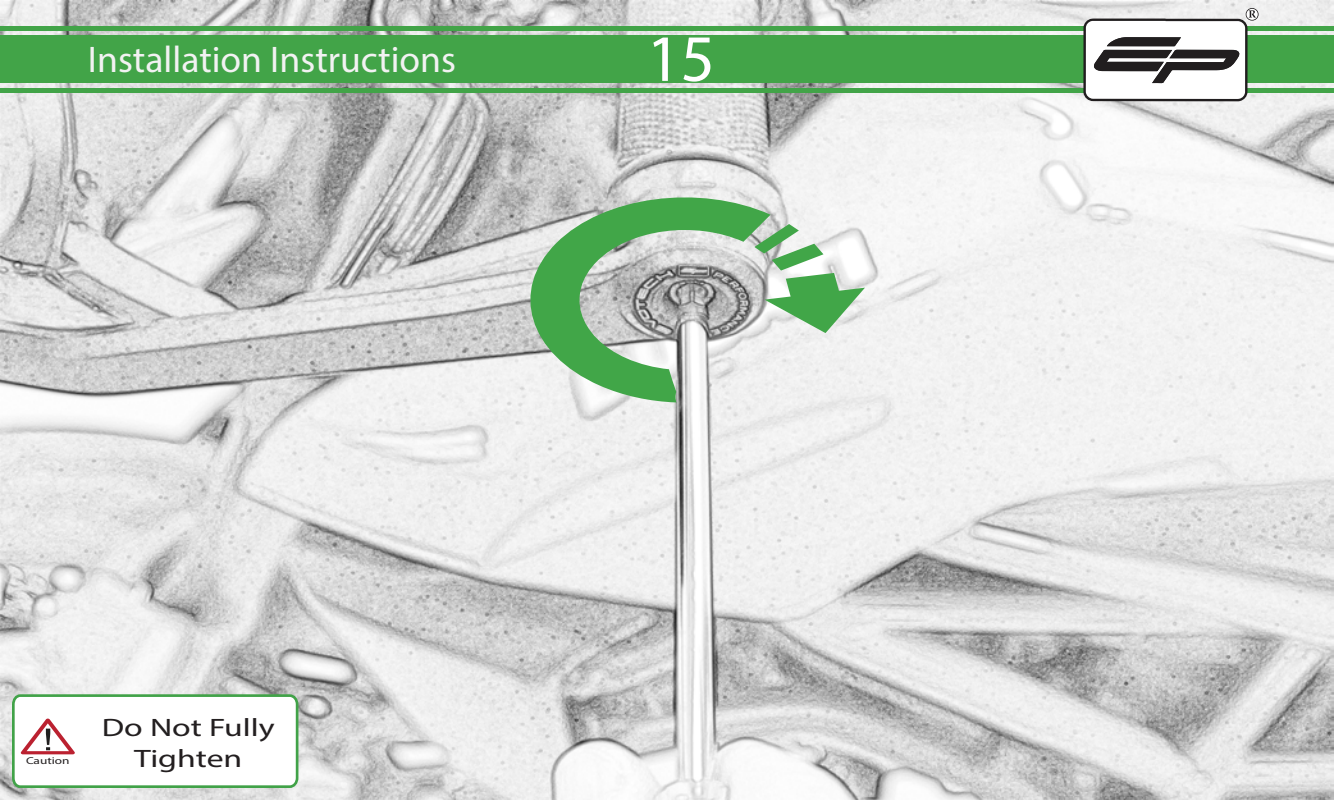

Caution

Do Not Fully
Tighten

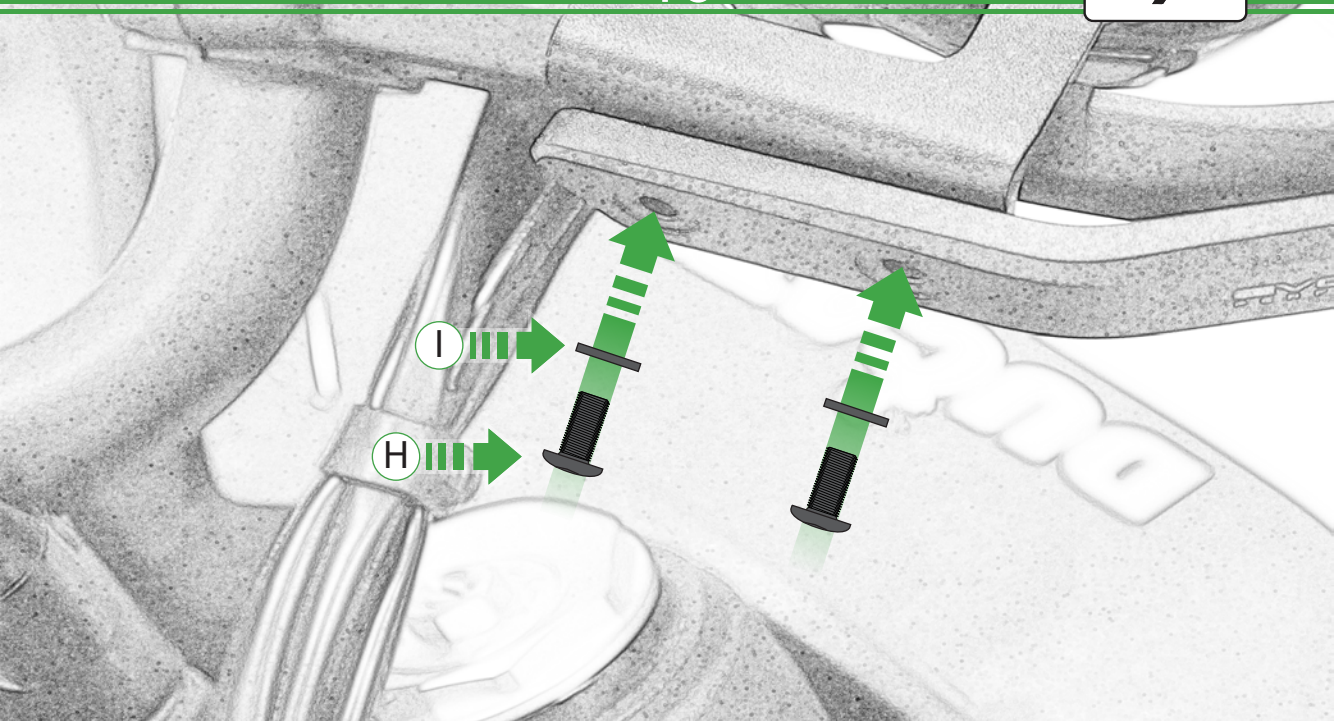

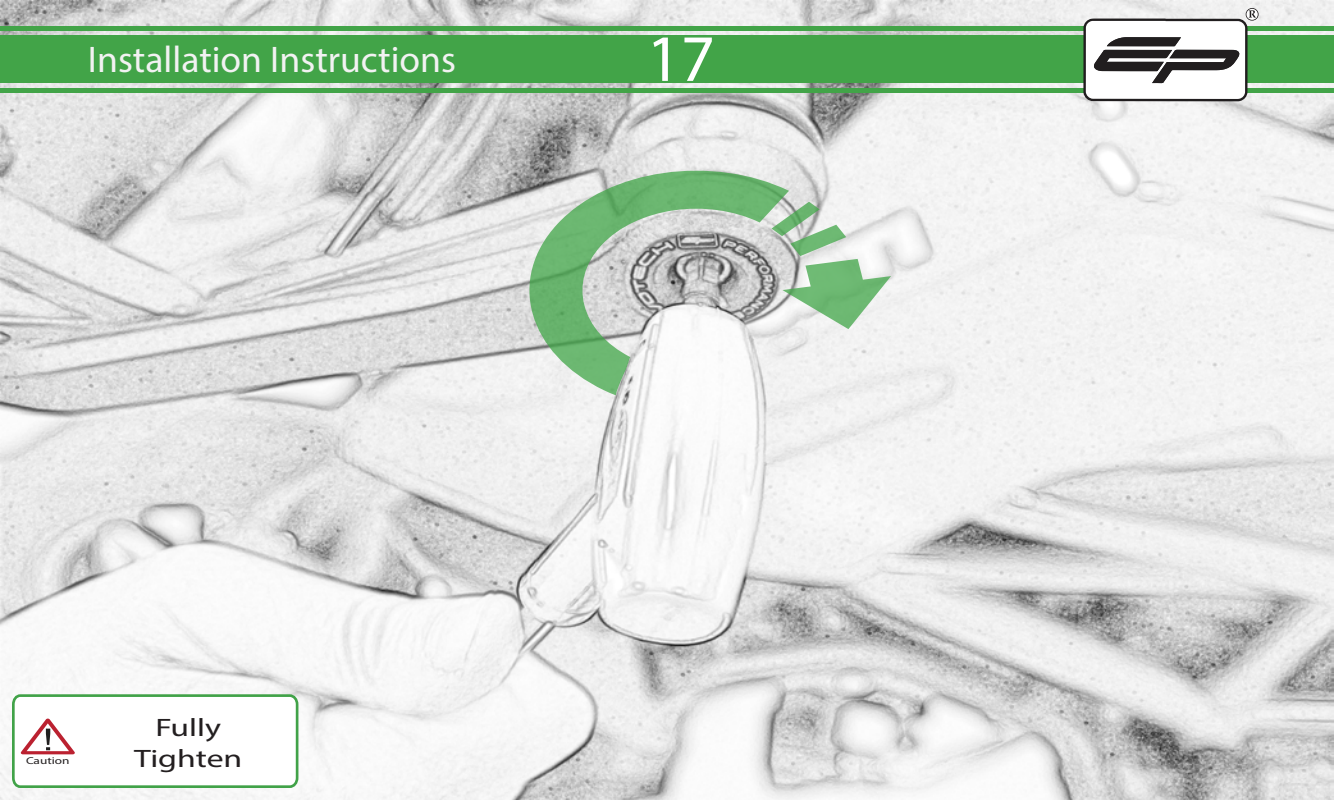

Caution

Fully
Tighten

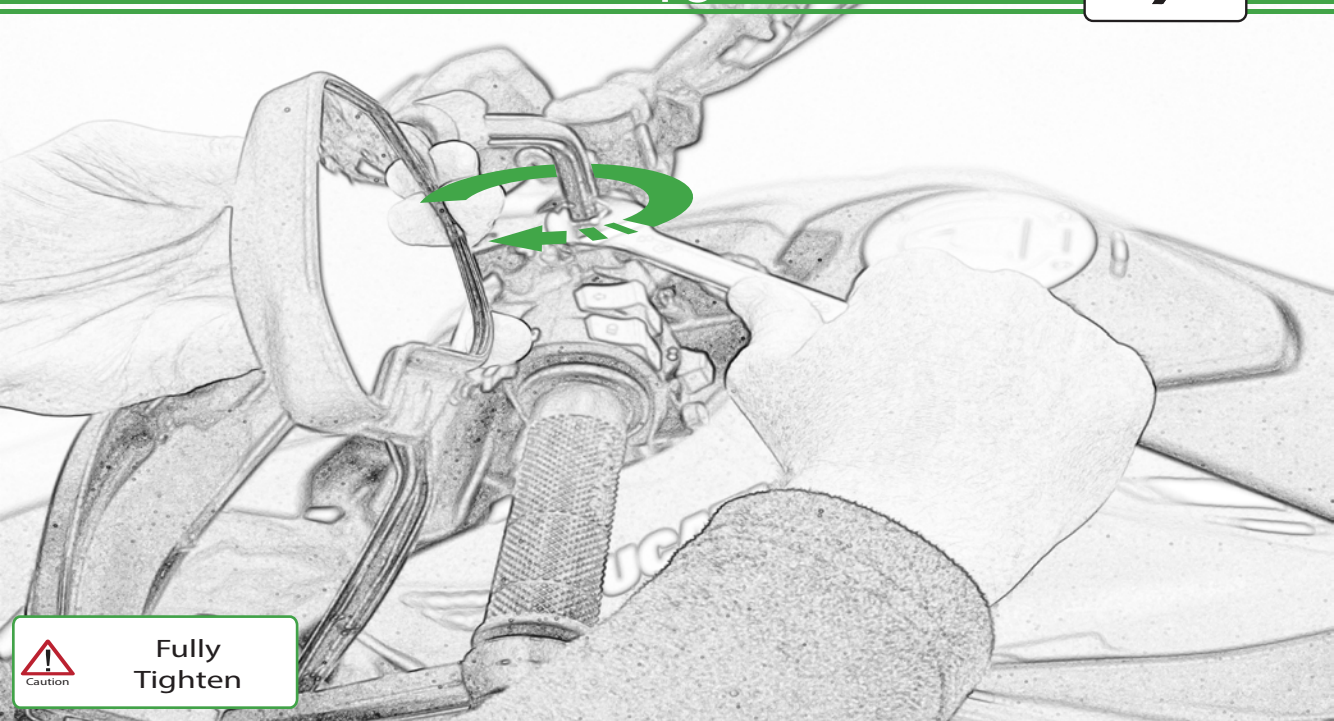

Caution

Fully
Tighten

A large, light gray version of the EP logo is centered in the background of the instruction box. Overlaid on the left side of this logo are two green chevrons pointing to the left.

Repeat Stages
1 - 18 For
Right Hand Side



Caution

Right Hand Mirror
Left Hand Thread



EVOTECH®
P E R F O R M A N C E

www.evotech-performance.com